

CORE SETS

Effective core parameters

SYMBOL	PARAMETER	VALUE	UNIT
$\Sigma (l/A)$	core factor (C_1)	0.42	mm^{-1}
V_e	effective volume	1476.57	mm^3
l_e	effective length	24.90	mm
A_e	effective area	59.30	mm^2
A_{\min}	minimum area	55.0	mm^2
W_t	mass of core set	≈ 8.1	g

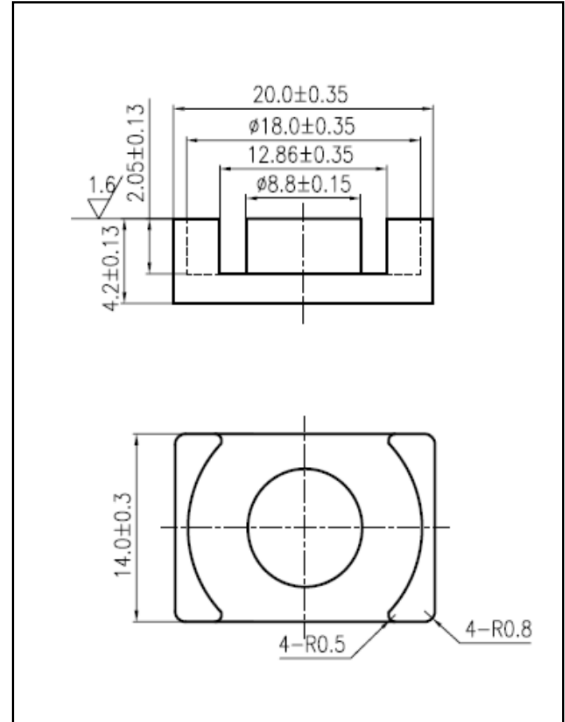

Characteristic

GRADE	AL (nH/N^2)	B (mT)	CORE LOSS (W)
	f=10kHz U=0.25V	H=250A/m f=25kHz T=100°C	f=100kHz B=200mT T=100°C
DMR40	$4100 \pm 25\%$	≥ 320	≤ 1.10
DMR44	$4100 \pm 25\%$	≥ 320	≤ 0.89
DMR95	$4800 \pm 25\%$	≥ 340	≤ 0.81