

CORE SETS

Effective core parameters

SYMBOL	PARAMETER	VALUE	UNIT
$\Sigma (1/A)$	core factor (C_1)	0.57	mm^{-1}
V_e	effective volume	7845.70	mm^3
l_e	effective length	67.00	mm
A_e	effective area	117.10	mm^2
A_{\min}	minimum area	117.10	mm^2
W_t	mass of core set	≈ 40.2	g

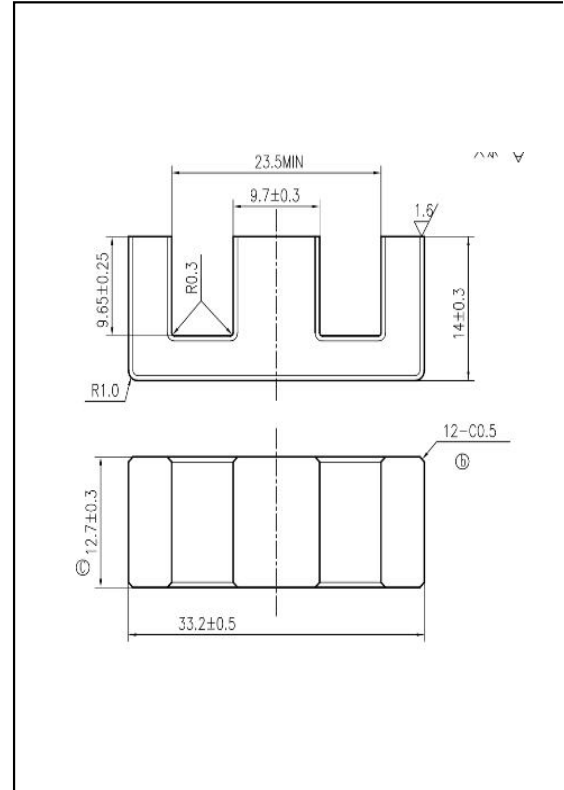

Characteristic

GRADE	AL (nH/N^2)	B (mT)	CORE LOSS (W)
	f=10kHz U=0.25V	H=250A/m f=25kHz T=100°C	f=100kHz B=200mT T=100°C
DMR40	$3800 \pm 25\%$	≥ 320	≤ 4.83
DMR44	$3800 \pm 25\%$	≥ 320	≤ 4.42
DMR47	$4000 \pm 25\%$	≥ 340	≤ 3.82
DMR95	$5000 \pm 25\%$	≥ 340	≤ 3.92

0.57	67.0	117.1	40.2*
-------------	-------------	--------------	--------------

