

#### CORE SETS

##### Effective core parameters

SYMBOL	PARAMETER	VALUE	UNIT
$\Sigma (1/A)$	core factor ( $C_1$ )	0.68	$\text{mm}^{-1}$
$V_e$	effective volume	9639.0	$\text{mm}^3$
$l_e$	effective length	81.0	mm
$A_e$	effective area	119.0	$\text{mm}^2$
$A_{\min}$	minimum area	114.5	$\text{mm}^2$
$W_t$	mass of core set	$\approx 49.1$	g

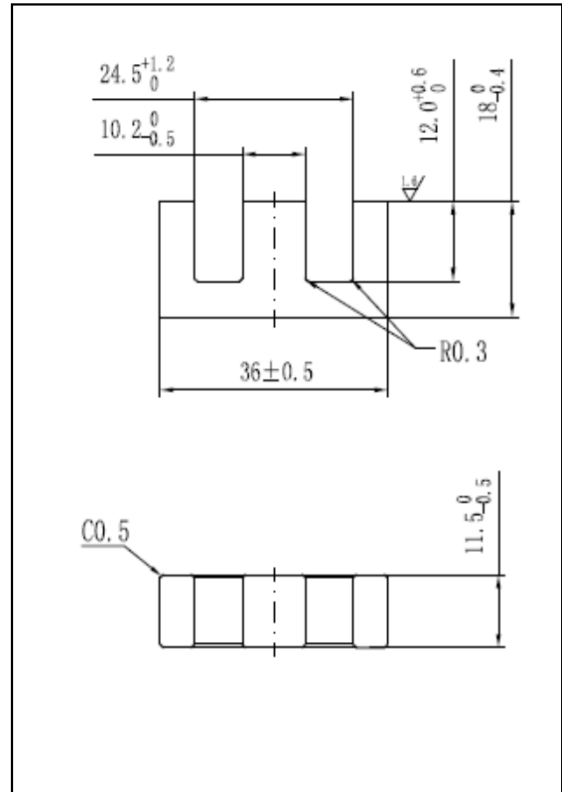

#### Characteristic

GRADE	AL ( $\text{nH/N}^2$ )	B (mT)	CORE LOSS (W)
	$f=10\text{kHz}$ $U=0.25\text{V}$	$H=250\text{A/m}$ $f=25\text{kHz}$ $T=100^\circ\text{C}$	$f=100\text{kHz}$ $B=200\text{mT}$ $T=100^\circ\text{C}$
DMR40	$3100 \pm 25\%$	$\geq 320$	$\leq 5.94$
DMR44	$3100 \pm 25\%$	$\geq 320$	$\leq 5.00$
DMR95	$4500 \pm 25\%$	$\geq 340$	$\leq 5.30$