

CORE SETS

Effective core parameters

SYMBOL	PARAMETER	VALUE	UNIT
$\Sigma (1/A)$	core factor (C_1)	0.84	mm^{-1}
Ve	effective volume	19177.0	mm^3
le	effective length	127.0	mm
Ae	effective area	151.0	mm^2
Amin	minimum area	233.0	mm^2
Wt	mass of core set	≈ 101.0	g

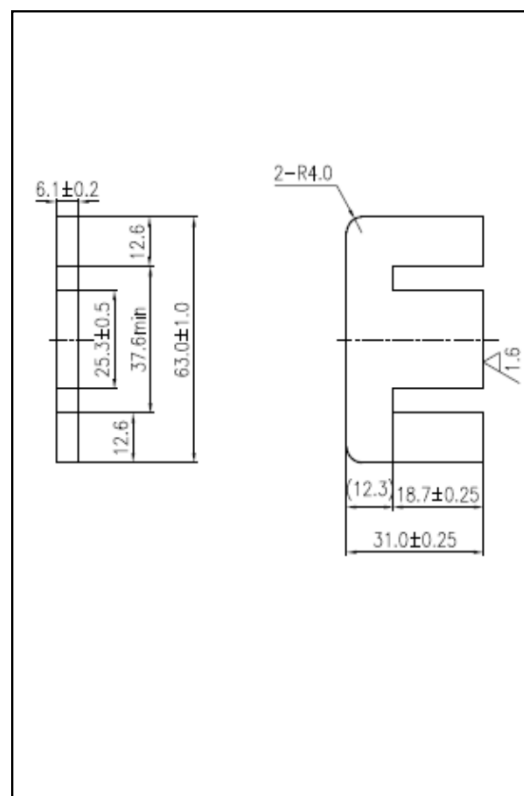

Characteristic

GRADE	AL (nH/N^2)	B (mT)	CORE LOSS (W)
	f=10kHz U=0.25V	H=250A/m f=25kHz T=100°C	f=100kHz B=200mT T=100°C
DMR40	$3000 \pm 25\%$	≥ 320	≤ 12.12
DMR44	$3000 \pm 25\%$	≥ 320	≤ 11.11

0.84	127.0	151.0	101*
-------------	--------------	--------------	-------------
