

### CORE SETS

#### Effective core parameters

SYMBOL	PARAMETER	VALUE	UNIT
$\Sigma (1/A)$	core factor ( $C_1$ )	2.93	$\text{mm}^{-1}$
$V_e$	effective volume	993.6	$\text{mm}^3$
$l_e$	effective length	54.0	mm
$A_e$	effective area	18.4	$\text{mm}^2$
$A_{\min}$	minimum area	15.8	$\text{mm}^2$
$W_t$	mass of core set	$\approx 5.3$	g

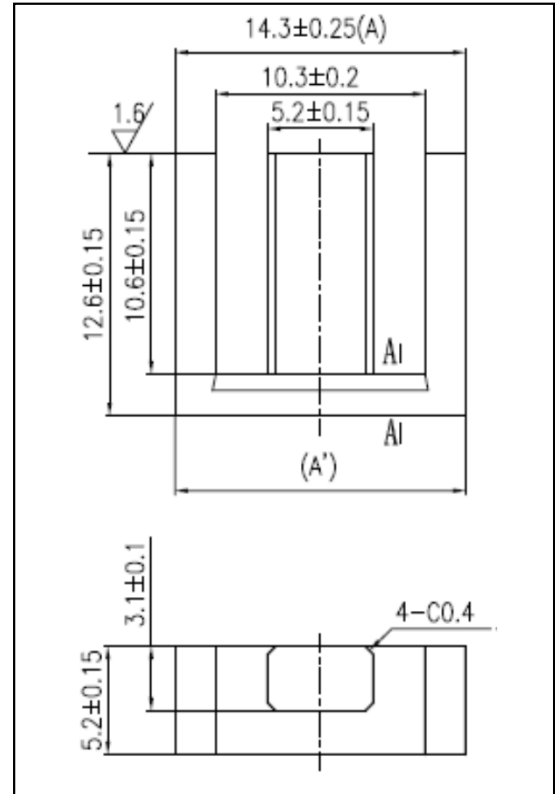

### Characteristic

GRADE	$AL (\text{nH}/\text{N}^2)$	$B (\text{mT})$	CORE LOSS (W)
	$f=10\text{kHz}$ $U=0.25\text{V}$	$H=250\text{A/m}$ $f=25\text{kHz}$ $T=100^\circ\text{C}$	$f=100\text{kHz}$ $B=200\text{mT}$ $T=100^\circ\text{C}$
DMR40	$720 \pm 25\%$	$\geq 290$	$\leq 0.77$
DMR44	$720 \pm 25\%$	$\geq 290$	$\leq 0.61$