

CORE SETS

Effective core parameters

SYMBOL	PARAMETER	VALUE	UNIT
$\Sigma (1/A)$	core factor (C_1)	0.99	mm^{-1}
V_e	effective volume	12712.36	mm^3
l_e	effective length	112.30	mm
A_e	effective area	113.20	mm^2
A_{\min}	minimum area	92.28	mm^2
W_t	mass of core set	≈ 64.6	g

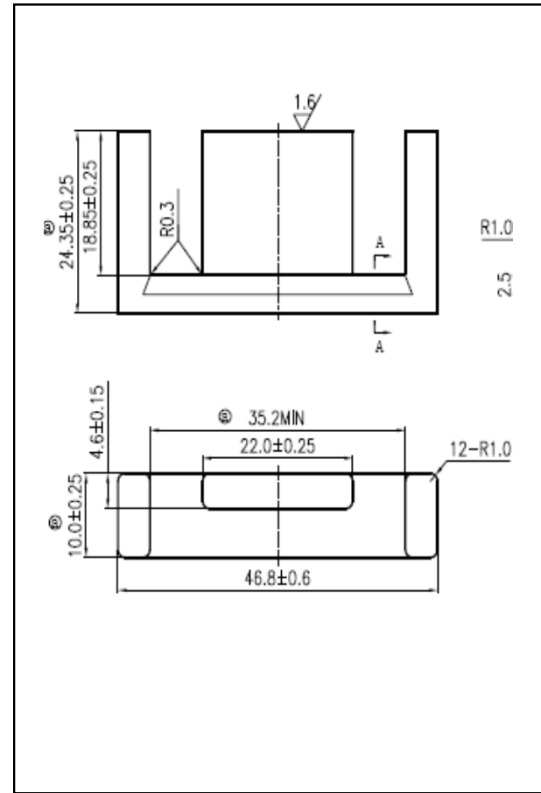

Characteristic

GRADE	AL (nH/N^2)	B (mT)	CORE LOSS (W)
	f=10kHz U=0.25V	H=250A/m f=25kHz T=100°C	f=100kHz B=200mT T=100°C
DMR40	$2100 \pm 25\%$	≥ 315	≤ 8.4
DMR44	$2100 \pm 25\%$	≥ 315	≤ 7.1
DMR95	$2500 \pm 25\%$	≥ 315	≤ 7.0